

راجبكو
Rajabco



Rajabco

الكرافانات / بورتا كابن / بيت جاهز
CARAVANS / PORTACABINS / PRE FAB HOUSES



نحن نحن

رجبكو هو التغير شركة محدودة مسجلة لدى بلدية أبوظبي

الأنشطة الرئيسية للشركة للتجارة وتصنيع وتركيب وصيانة
للبيوت الجاهزة والمحمولة

وتقع الشركة في منطقة مصفح الصناعية ومجهزة المهنية
للموظفين والتي تنعكس على نوعية المنتجات

نحن العادية الموردين الرئيسيين لشركات البناء والتشييد في
دولة الإمارات العربية المتحدة

أنشئت الشركة في عام ٢٠٠٥ ولدينا خبرة واسعة في مجال /
الكرافانات / بورتا كابين / بيت جاهز / والتركيب

نحن يتأهب أن يجبك استعلامك

نؤكد لكم خدماتنا الجديدة

اتصال

■ بي. عمر

+٩٧١ ٥٠ ٦٦٦٩٠٨٢

■ نياس عمر

+٩٧١ ٥٠ ٥٤٢٤٧٧٩





Rajabco is a limited liability company registered with Abu Dhabi Municipality.

The main activities of the company is Trading, Fabrication, Installation, Maintenance of Portacabins and Prefab Houses.

The company is located in Mussaffah industrial area and equipped with professional employees which is reflected on our quality products.

We are regular suppliers for major contracting and construction companies in U.A.E.

The company is established in 2005 and we have ample experience in the field of PORTACABIN / PREFAB HOUSE / CARVANS and its installation.

We are ready to answer your enquiries at any time

Assuring you our best services.

Contact

- *P. Umer*
MOB.: +971 50 666 9082
- *Niyas Umer*
MOB.: +971 50 542 4779

Rajabco



Specification of Portacabin

BASE

The base is made from steel Ibeams (120x 64x6mm) joined by welding and it is supported on steel legs 12cm height. On each 50cm distance 3x4" hardwood is used across for further support for the platform.

FLOOR

The floor of the unit is made by 18mm Indonesian plywood. Top finish is PVC tiles 30x30cm. Inside the toilet and kitchen PVC sheets are used to ensure 100% waterproofing and quick drain. Wall of the toilet & kitchen is done by polyester plywood (water proof).

WALLS

Walls are manufactured as sandwich type panel with 50mm polystyrene insulation and all electrical works are concealed. The frame is covered by 4mm plywood from outside and inside with decorative plywood. The ceiling is by 4mm plywood painted with good quality plastic emulsion paint. The ceiling is insulated by 25mm polystyrene sheets in between the roof and ceiling. All electrical lines are through pipes concealed inside the ceiling.

ROOF

Roof is made by corrugated sheets fixed on 2x2" wood fixed on wooden trusses.

DOORS & WINDOWS

Doors are semi solid polished and fixed with good quality locks. It is painted with varnish or good quality enamel paints. Windows are aluminium sliding with flyscreen silver or bronze colour and the size is 90x90cm.

TOILET & KITCHEN

Toilet is complete with W.C., Wash basin, Shower tray, Water heater, Mirror, Mirror tray, ect.. Kitchen is with stainless steel sink housed in aluminium cabinet and good quality mixers and water heater (Ariston).

PAINTING

All structural works is cleaned and applied 2 coats of red oxide primer and 2 coats of enamel paint. The Outside walls are applied one coat primer and final by heavy textured paints.

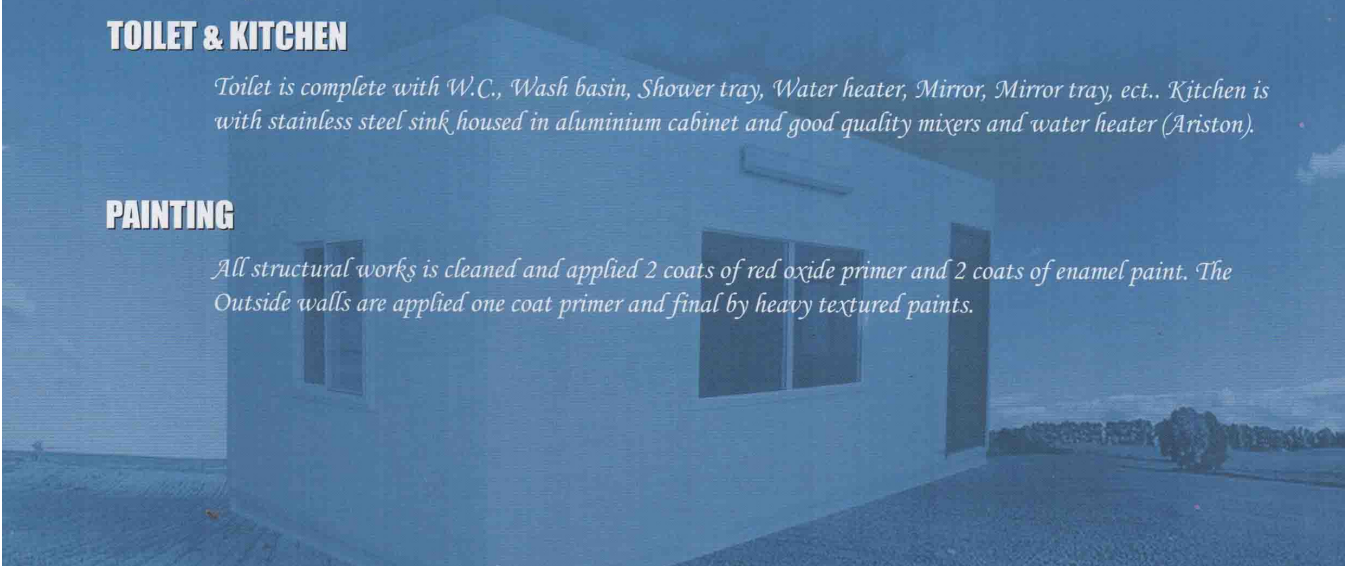

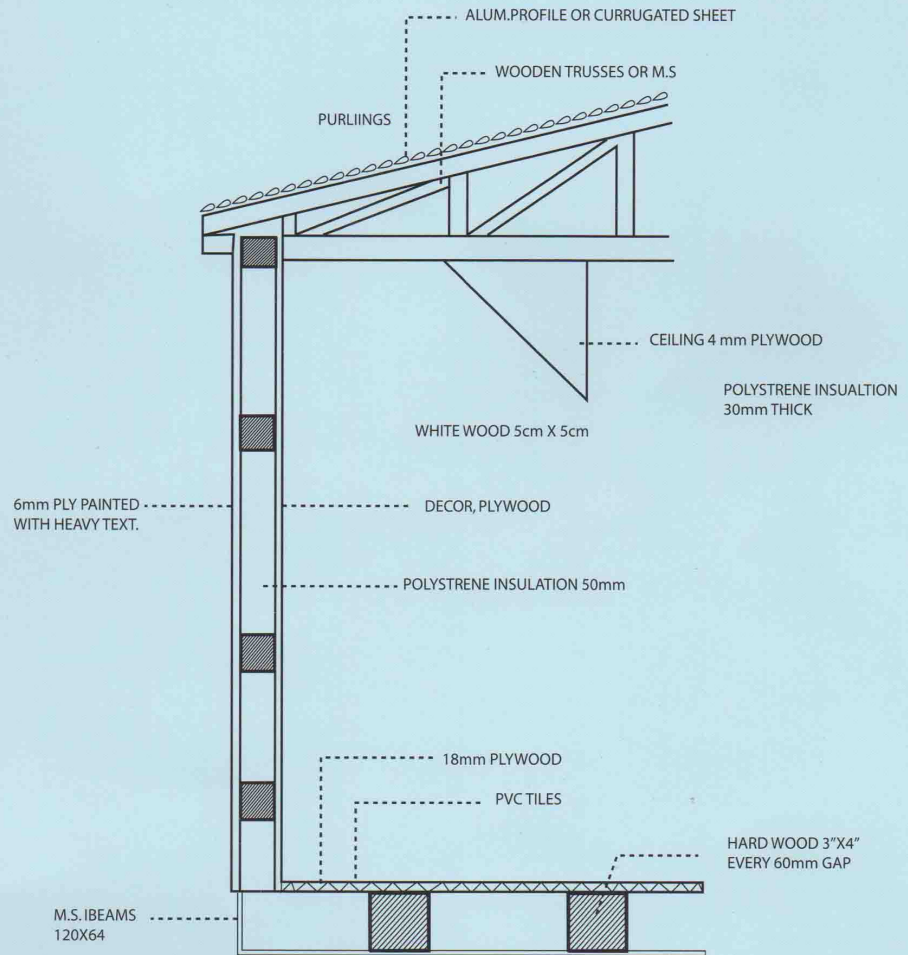

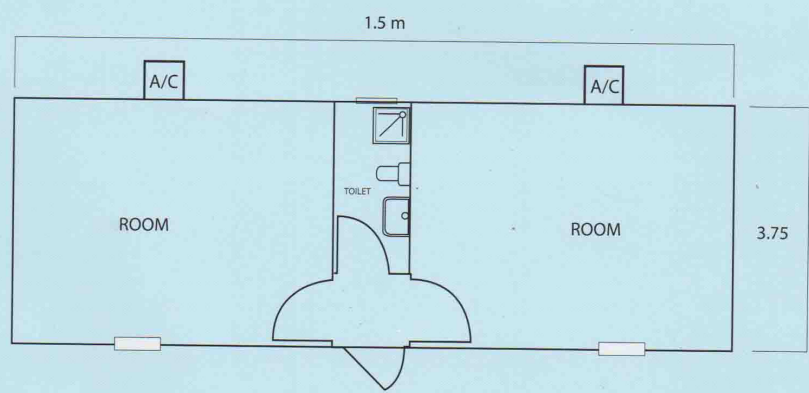
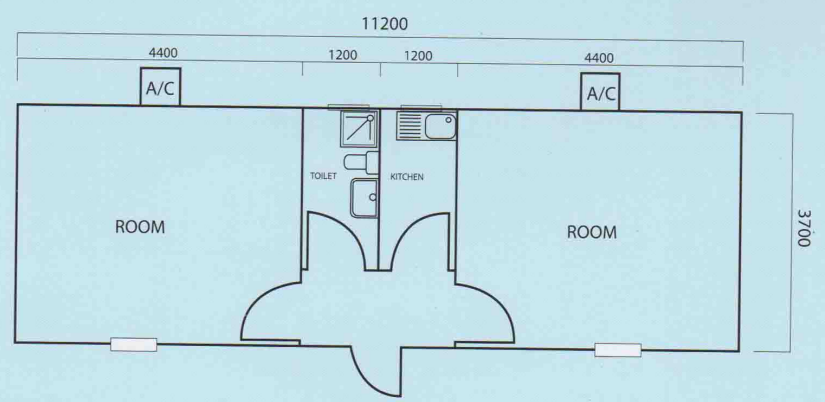
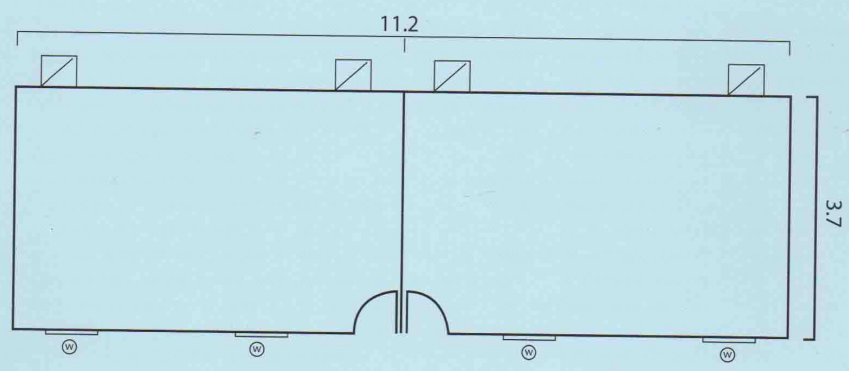

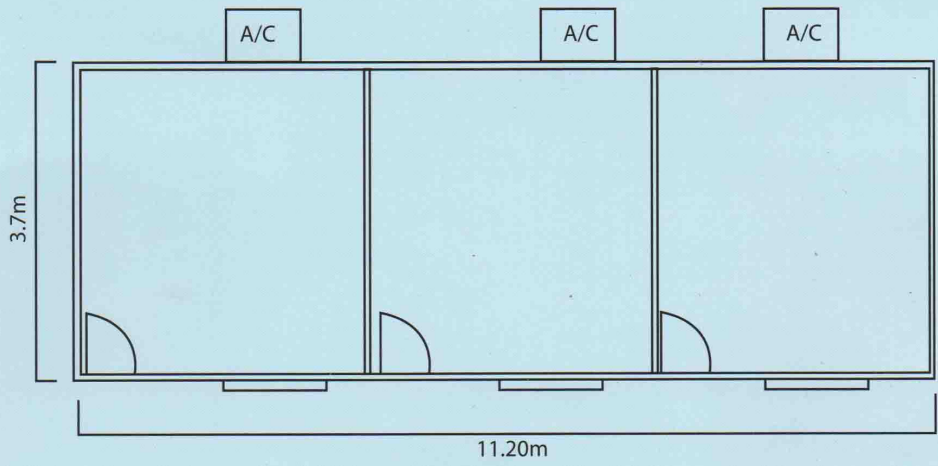
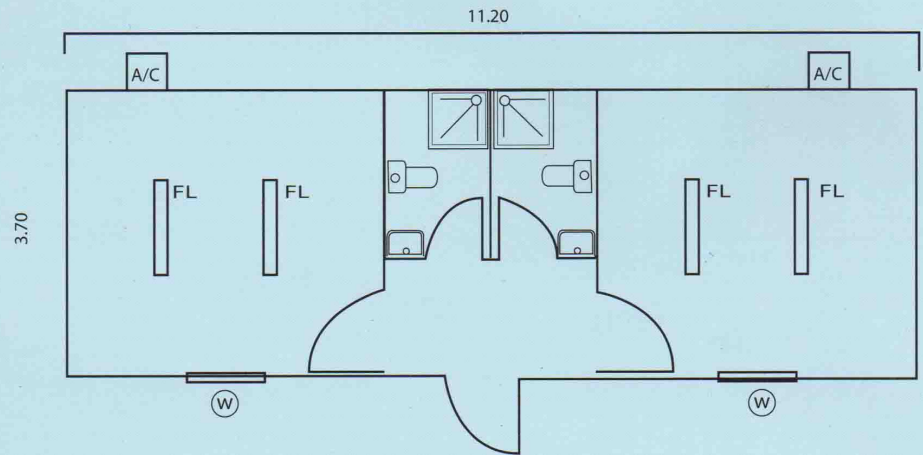
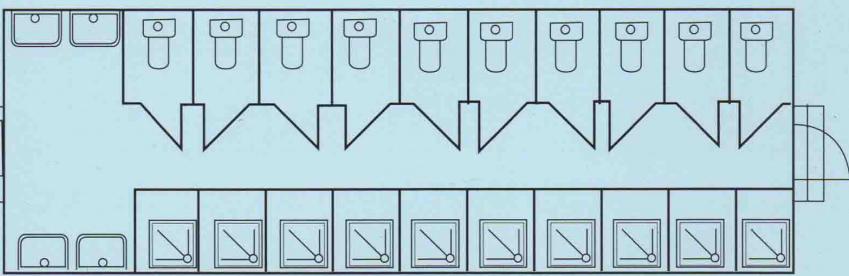

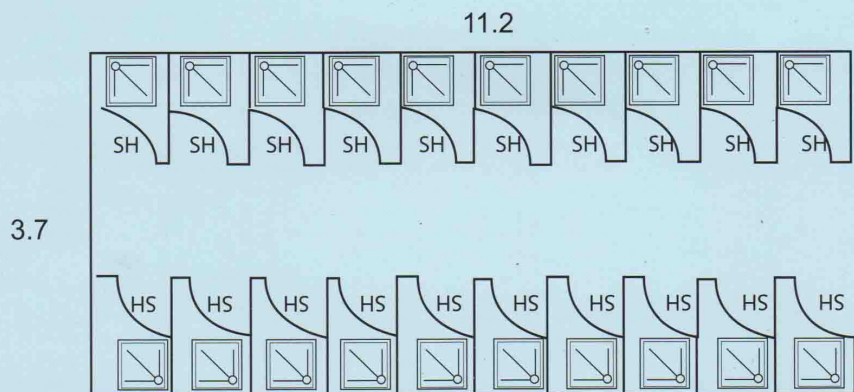
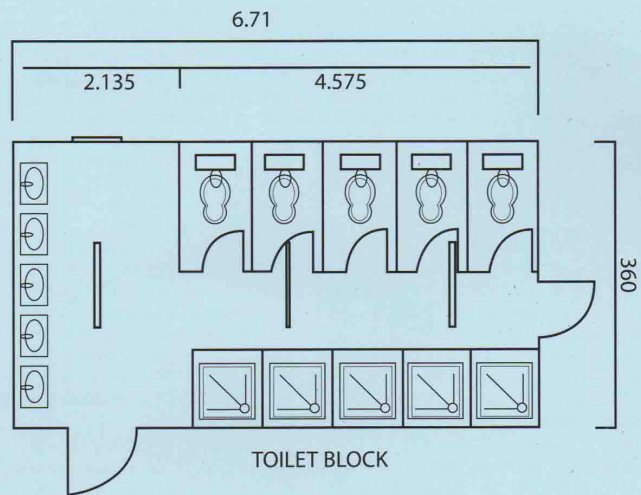
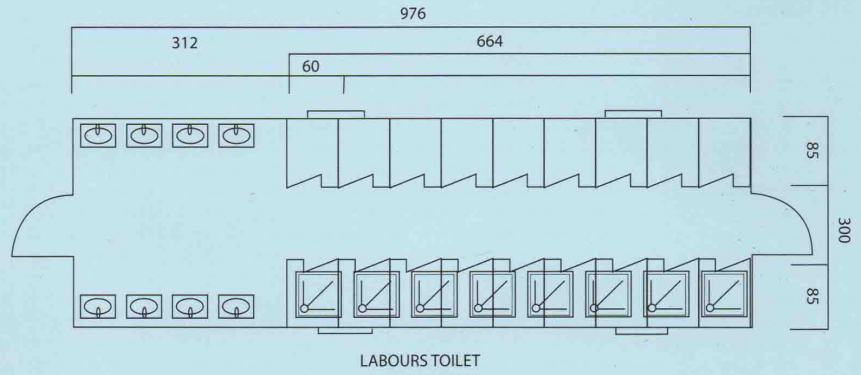
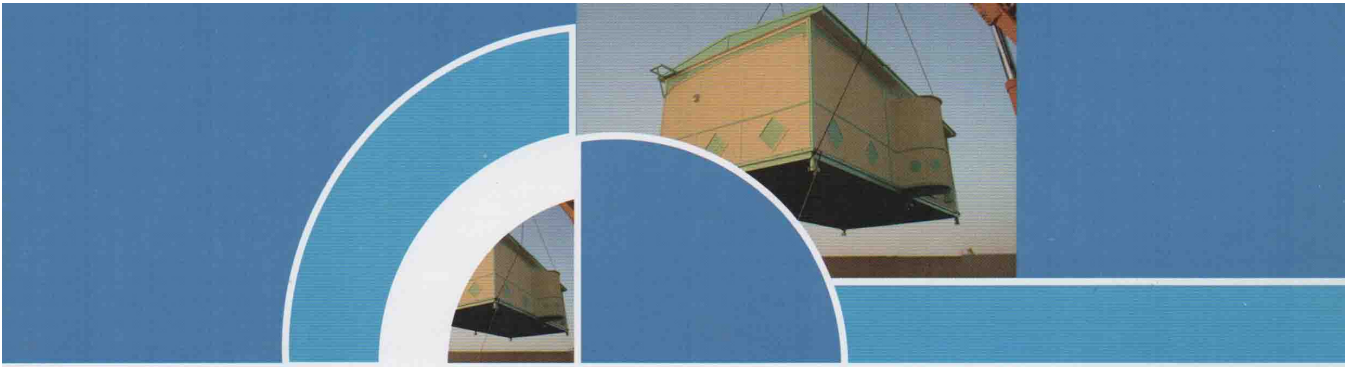

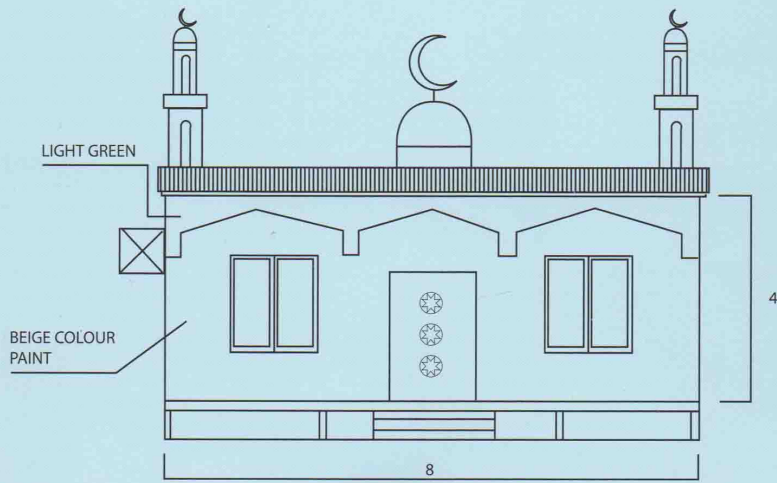

FRONT ELEVATION

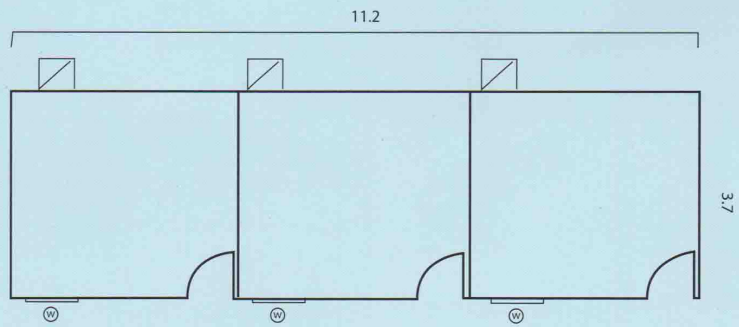

CARAVAN WITH THREE ROOMS

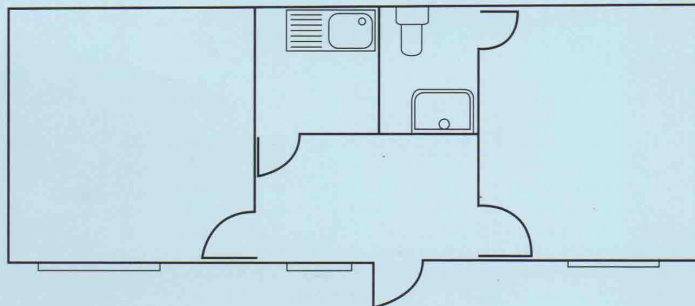

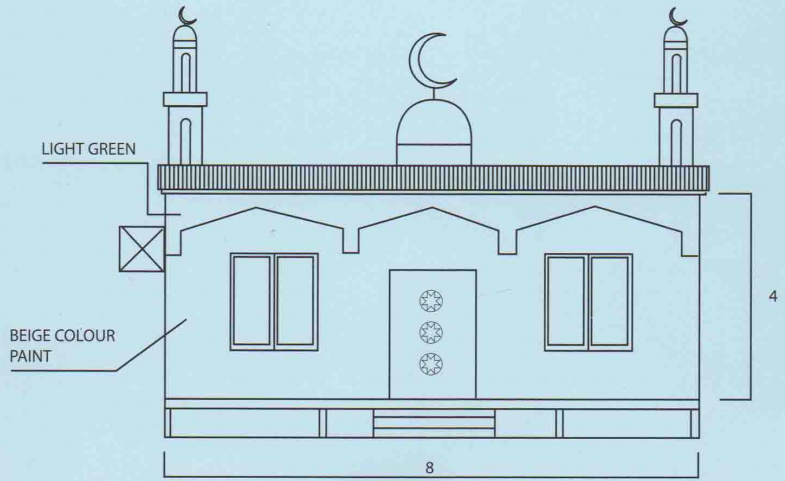

FRONT ELEVATION

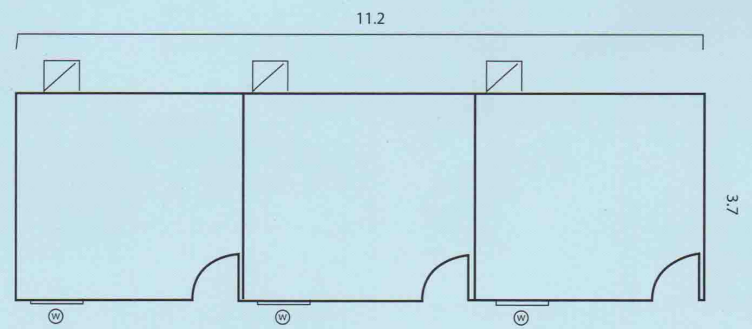

CARAVAN WITH THREE ROOMS

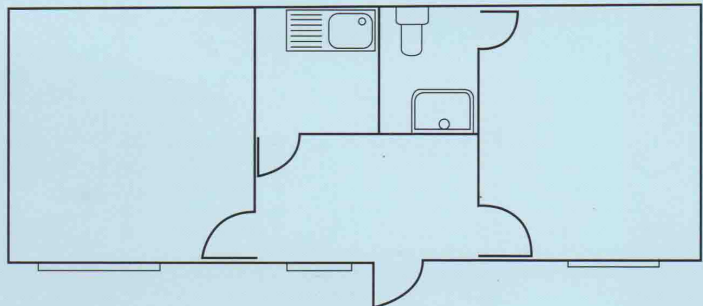

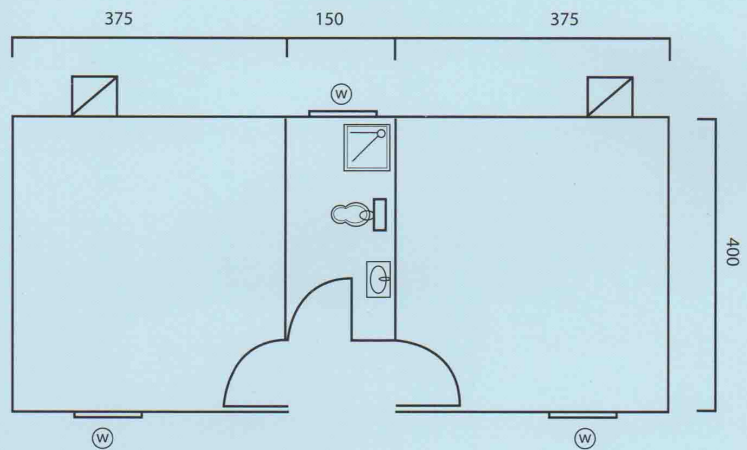
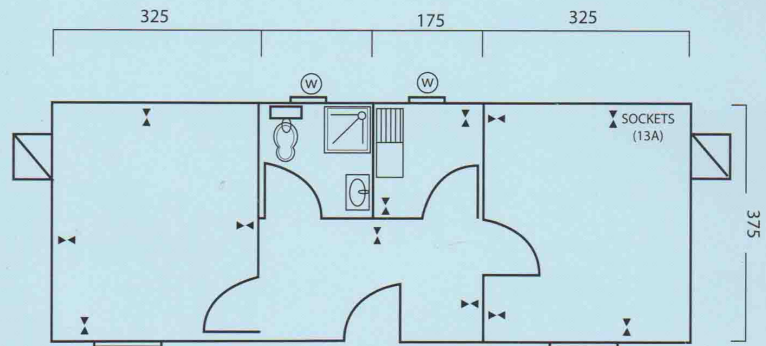

2 ROOMS WITH ONE BATHROOM

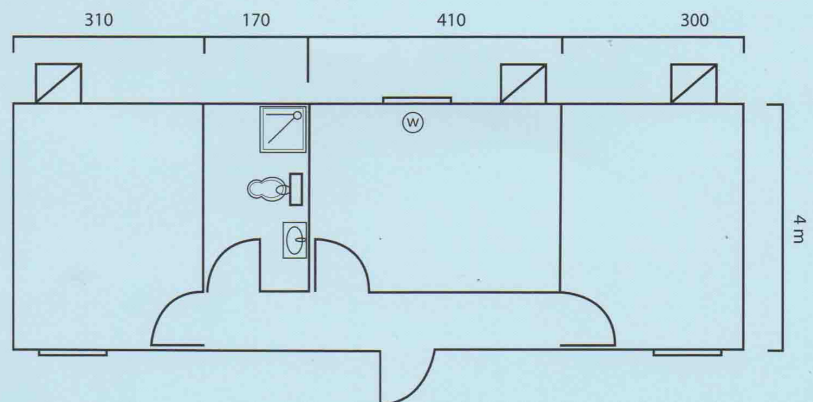

3 ROOMS WITH ONE BATHROOM

Caravans / Portacabins / Prefab Houses

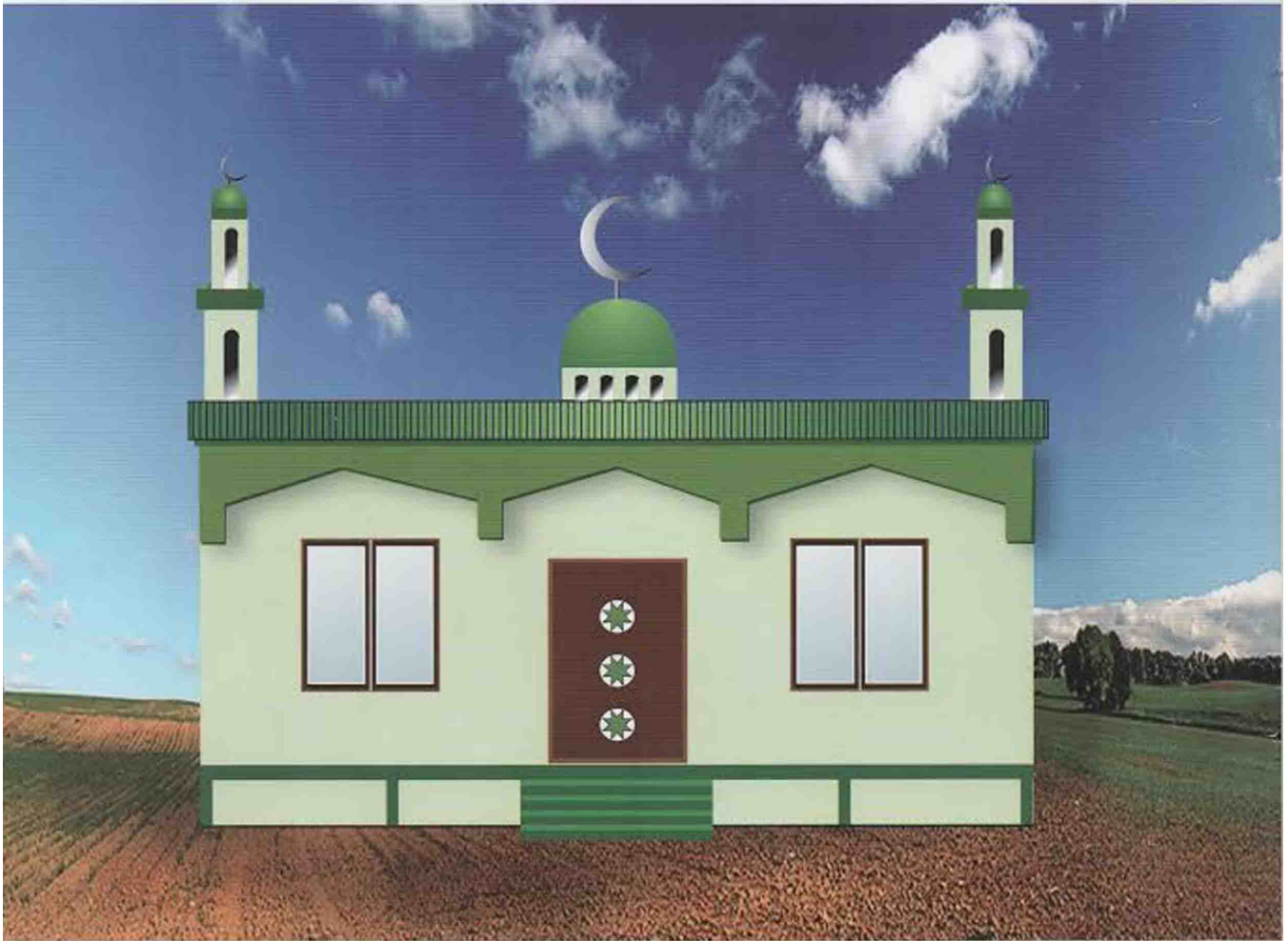

Rajabco

Tel.: +971 2 554 5852/ 554 5842 - Fax: +971 2 554 5853
Mob.: +971 50 666 9082 - P.O.Box: 108524 - Abu Dhabi
United Arab Emirates
E.mail: rajacom@emirates.net.ae